

# Quartet 650W

Our popular Quartet range of spotlights features a Fresnel, PC spot and two zoom profiles to meet a wide range of applications where a small powerful light source is needed. The whole range shares a common lamp family, allowing users to stock a single lamp type for up to four luminaire styles. Ideal for small entertainment and display applications, there is a Quartet spotlight to meet your needs.



Quartet Zoom  
(15/25 and 22/40)



Quartet PC/F

## Features

- Range includes:
  - Quartet F** Fresnel with 10° to 40° soft edged beam
  - Quartet PC** PC spot with 7.5° to 55.5° beam
  - Quartet 15/25** Variable profile spot with 15° to 25° beam
  - Quartet 22/40** Variable profile spot with 22° to 40° beam
- Profile spot optics are designed for improved output and cleaner beam distribution for crisper shuttering and gobo projection
- Lens mechanism ensures smoother beam adjustments
- Compact, lightweight yet ruggedly constructed
- ETL listed

## SPECIFICATION SUBMITTAL

CONSULTANT <input type="text"/>	PROJECT NAME: <input type="text"/>	MODEL NUMBER   QUANTITY: <input type="text"/> <input type="text"/> <input type="text"/> <input type="text"/> <input type="text"/> <input type="text"/> <input type="text"/> <input type="text"/>
DATE: <input type="text"/>	PROJECT NUMBER: <input type="text"/>	APPROVED BY: <input type="text"/>

### Photometric data:

Typical performance based on 650W lamp.

Quartet F: Narrow

Distance (ft)	15	20	25	30
Beam Ø (ft)	1.8	2.4	3.0	3.6
Illum FC	189	107	68	47

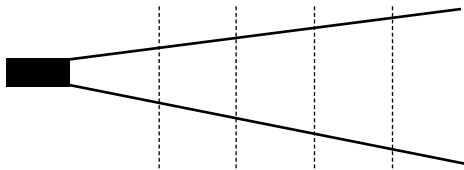

Quartet PC: Narrow

Distance (ft)	15	20	25	30
Beam Ø (ft)	2.0	2.6	3.3	3.9
Illum FC	261	147	94	65

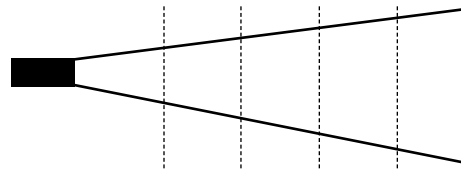

To calculate FC levels at any throw distance, divide the following factors by the distance squared:

	<b>F</b>		<b>PC</b>	
	N	W	N	W
FC	75900	9930	58700	5500

To calculate beam diameters at any throw distance, multiply the throw in feet by:

	<b>F</b>		<b>PC</b>	
	N	W	N	W
Dia	0.12	0.83	0.13	1.05

## Strand Theatre Lighting

Quartet 15/25: Narrow

Distance (ft)	15	20	25	30
Beam Ø (ft)	3.9	5.2	6.5	7.8
Illum FC	362	204	130	91

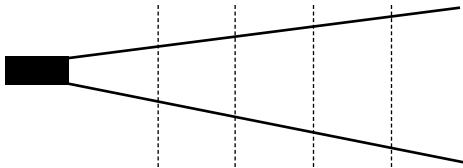

Quartet 22/40: Narrow

Distance (ft)	15	20	25	30
Beam Ø (ft)	5.9	7.8	9.8	11.7
Illum FC	238	134	86	59

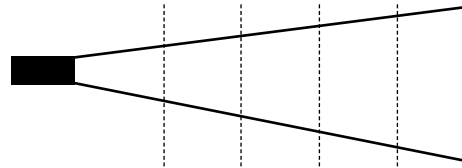

Quartet 15/25: Wide

Distance (ft)	15	20	25	30
Beam Ø (ft)	6.6	8.8	11.0	13.2
Illum FC	142	80	51	36

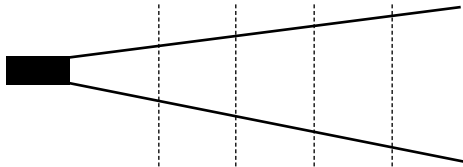

Quartet 22/40: Wide

Distance (ft)	15	20	25	30
Beam Ø (ft)	11.0	14.6	18.3	22.0
Illum FC	189	107	68	47

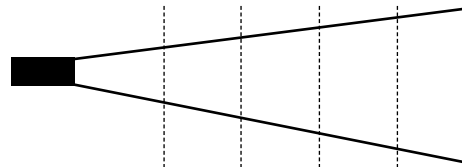

To calculate FC levels at any throw distance, divide the following factors by the distance squared:

	15/25		22/40	
	N	W	N	W
FC	81550	31970	53500	42600

To calculate beam diameters at any throw distance, multiply the throw in feet by:

	15/25		22/40	
	N	W	N	W
Diam	0.26	0.44	0.39	0.73

## Strand Theatre Lighting

### Operational Features

**Lamp access** – Through drop-down lamp tray secured by quarter turn fastener

**Focus adjustment** – By locking screw handle on underside of F and PC lamphouse

By locking screw handles on side of profile lens tube

**Lamp adjustment** – Beam distribution on profiles adjusted by locking screw handle on underside of lamphouse

### Electrical & Mechanical Data

**Construction** – Die-cast aluminium lamphouses with extruded aluminium lens tubes on profiles finished in black epoxy powder coating

**Gate** – Sprung assembly houses four removable beam-shaping shutters and has runners to take gobo holder or drop in iris diaphragm

**Lenses** – Heat resistant borosilicate glass lenses. F & PC lenses mounted in front of die-cast lamphouse. Profile lenses mounted in die-cast carriers sliding on Teflon guides

**Supply voltage** – 120V ± 10% 50/60Hz

<b>Lamps</b> – FRG 500W	150 hours
FRK 650W	200 hours
FRE 650W	500 hours
JCS120V-575WC (Ushio) 575 watt	300 hours
JCS120V-575WC (Ushio) 575 watt	1500 hours

### Weights and Dimensions

	F	PC	15/25	22/40
Weight	7lb	7lb	12lb	12lb
Packed weight	9lb	9lb	13lb	13lb

Quartet F

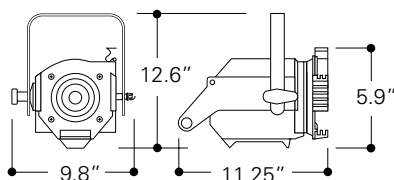

Quartet PC

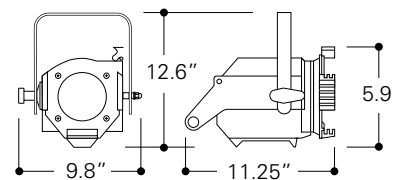

Quartet 15/25  
Quartet 22/40

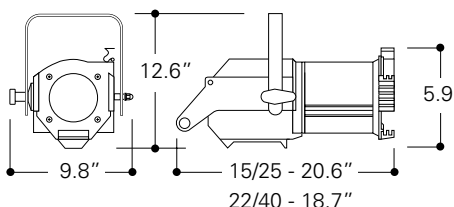

## Ordering Information

### Cat No Description

Quartet spotlights are supplied with 3 ft. of cable, color frame and C-clamp.

11165	Quartet F
11175	Quartet PC, 120V
11185	Quartet 15/25, 120V
11195	Quartet 22/40, 120V

For connector options please specify GR, GP, or GTL when ordering.

### Optional accessories

18040	Barndoor, 4-leaf rotatable
18041	Iris, 12-leaf
18042	Holder for M-size gobo
18044	Color frame, metal
82003	Safety cable

### Strand Lighting, Inc. Strand Lighting Europe Limited

6603 Darin Way  
Cypress, CA 90630  
Tel: (714) 230-8200  
Fax: (714) 899-0042

Unit 2 Royce Road, Fleming Way  
Crawley, West Sussex RH10 9JY  
Tel: + 44 (0) 1293 554010  
Fax: + 44 (0) 1293 554019

### Strand Lighting Asia Limited

20/F Delta House,  
3 On Yiu Street  
Shatin, N.T. Hong Kong  
Tel: +852 2757 3033  
Fax: +852 2757 1767

[www.strandlighting.com](http://www.strandlighting.com)

© Philips Group 2008  
All rights reserved.  
The Company reserves the right to make any variation in design or construction to the equipment described. E&OE